



# INSTALLATION INSTRUCTIONS

UMI Performance Inc,  
509 Hemlock Street  
Philipsburg, PA 16866  
814-343-6315  
support@umiperformance.com

## Part #4080-1 Splined Front Sway Bar 1964 - 1972 GM A - Body 1970 - 1981 GM F - Body



### Applications

1964-1967 GM A-Body      1970-1981 GM F-Body  
1968-1972 GM A-Body

### Included Parts

| Part #  | Quantity | Description   |
|---------|----------|---|
|         | 1        | 1.25" Solid Splined Sway Bar - Powdercoated         |
|         | 2        | 1.25"-49 Spline Sway Bar Arm - Powdercoated         |
| 4080F   | 2        | Aluminum Sway Bar relocation bracket                |
| 88-1179 | 1        | Sway bar bushings and clamshells – Red polyurethane |
|         | 1        | 2649 Endlink Kit – separate bag                     |
| 1000003 | 2        | 3/8-16 x 1 ¼ gr 8 hex bolt                          |
| 1000065 | 2        | 3/8-16 x 2 ½ gr 5 hex bolt                          |
| 1000072 | 2        | 3/8-16 x 1 ½ gr 8 hex bolt                          |
| 1000081 | 2        | 3/8-16 x 1 gr 8 hex bolt                            |
| 1000101 | 6        | 3/8-16 Nylock nut                                   |
| 1000102 | 4        | 3/8-16 x 2 gr 8 hex bolt                            |
| 1000130 | 12       | 3/8 AN Washer .060 Thick                            |
|         | 2        | 1 ¼ Collar clamps                                   |

## Installation

1. Lift front of vehicle using your preferred method. Use a vehicle lift or jack and jack stands.
2. Remove wheels from vehicle to gain working access.
3. Remove existing front sway bar and end links.

4. **1964 – 1967 cars** – If sway bar hardware is 5/16-18 thread (1/2" socket to remove)

Drill the factory sway bar mounting holes and tap with 3/8-16 RH Tap. Drill size is 5/16

This step is not required for cars using factory 3/8" hardware

5. Install Aluminum Sway Bar Relocation bracket onto frame. Use the supplied 3/8-16 x 1 1/4" bolt, and washer in the countersunk hole. This will install in the front factory mounting hole. Install 3/8-16 x 1 1/2 in the slotted hole to align the bracket on the frame.

Tighten the front bolt to spec, then remove rear alignment bolt.

**\*\*NOTE\*\*** – If vehicle is equipped with UMI Front frame brace (UMI2654 or UMI4063) install the relocation bracket on the bottom side of the brace, "sandwiching" the brace.

**Hardware Required:**  
(2) 3/8-16 x 1 1/4" Bolt  
(2) 3/8 flat washer  
**Torque: 35 ft lb**



6. Preassemble Sway bar arms onto the spline bar before installing in car. The splined arms must be clocked the same, so that both ends will sit flat when sitting on a table or floor. If one arm is off, simply remove, clock 1 spline or more, then reinstall.

**\*\*TIP\*\*** Make a small mark on both end of the spline bar in line with the slot of the sway bar arm. This will give a correct orientation if the arm is ever removed and reinstalled.



7. Using the supplied 3/8-16 x 2 1/2" gr.5 (3 lines on bolt head) bolts, install sway bar arm clamp bolts from the top side down. Use a washer and 3/8-16 nylock to secure.

**Do not tighten at this time.**

**Hardware Required:**  
(2) 3/8-16 x 2 1/2" Bolt  
(2) 3/8 flat washer  
(2) 3/8-16 Nylock Nut  
**Torque: 35 ft lb**

8. Lightly grease the inside of the supplied sway bar bushings and install on the bar. Place the clamshell over the poly bushing

9. Install Sway bar onto car, making sure the heads of the sway bar arm bolts are on the top side. Adjusting the bushings side to side will be necessary to align the mounting holes. Use the supplied 3/8-16 x 1, 3/8-16 x 1 ½ bolts to attached the clamshell to the aluminum relocation bracket. Shorter bolt in the front hole, longer bolt in the rear.

**Hardware Required:**

- (2) 3/8-16 x 1" Bolt
- (2) 3/8-16 x 1 ½" Bolt
- (4) 3/8 flat washer

**Torque:** 35 ft lb

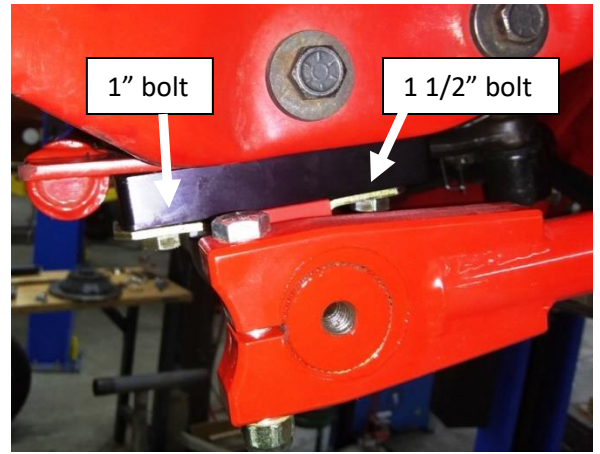

10. Install collar clamps onto the sway bar to eliminate side to side movement. These should be installed on the inside of the bushings, with a small (1/16") gap. Ensure to center the bar from side to side.

*As the bar rotates and twists, the length changes. This gap will eliminate any potential binding*

11. Install Sway bar endlinks. Follow the instructions for the endlink style included with your sway bar. The endlink varies between car models and control arm styles. Before installing, make sure you have the correct endlink for your application



## Sway Bar end link installation:

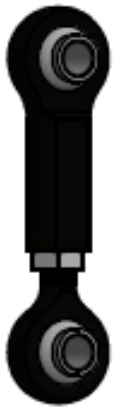

### **Part# UMI 2680** 1970-1981 GM F Body; Chevrolet Camaro, Pontiac Firebird

*For use with UMI Performance control arms, and any control arm using double shear mounting*

Install Sway bar link to the double shear control arm mount first, using supplied hardware. Then Install rod end to the Sway bar arm. Insert the bolt with washer from the frame side, the rod end will mount on the outside of the sway bar arm. The nut will clamp directly to the rod end to allow full articulation

#### **Hardware Required:**

- (4) 3/8-16 x 2" Bolt
  - (4) 3/8 flat washer
  - (4) 3/8-16 Nylock Nut
- Torque: 35 ft lb**



### **Part# UMI 4080** 1964-1972 GM A Body; Chevrolet Chevelle, Pontiac GTO, etc...

*For use with UMI Performance control arms, and any control arm using double shear mounting*

Install Sway bar link to the double shear control arm mount first, using supplied hardware. Then Install rod end to the Sway bar arm. Insert the bolt with washer from the frame side, the rod end will mount on the outside of the sway bar arm. The nut will clamp directly to the rod end to allow full articulation

#### **Hardware Required:**

- (4) 3/8-16 x 2" Bolt
  - (4) 3/8 flat washer
  - (4) 3/8-16 Nylock Nut
- Torque: 35 ft lb**

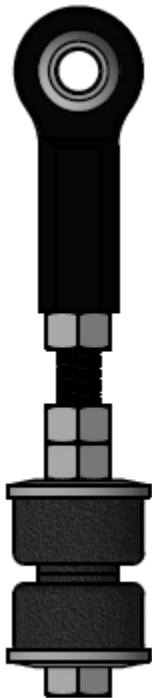

### **Part# UMI 4080-1** 1964-1972 GM A Body; Chevrolet Chevelle, Pontiac GTO, etc... 1970-1981 GM F Body; Chevrolet Camaro, Pontiac Firebird

*For use with control arms using biscuit style endlinks*

Follow instructions included in the UMI 2649 kit. Biscuit ends will mount on control arm side. Then Install rod end to the Sway bar arm. Insert the bolt with washer from the frame side, the rod end will mount on the outside of the sway bar arm. The nut will clamp directly to the rod end to allow full articulation

#### **Hardware Required:**

- (2) 3/8-16 x 2" Bolt
  - (2) 3/8 flat washer
  - (2) 3/8-16 Nylock Nut
- Torque: 35 ft lb**

The Sway bar is equipped with adjustable length sway bar arms. Changing the arm length adjusts the spring rate of the sway bar and changes the handling of the car.

In general,

**Stiffening** the front sway bar increases **understeer**

**Softening** the front sway bar increases **oversteer**

It is recommended to begin in hole #3 and adjust accordingly.

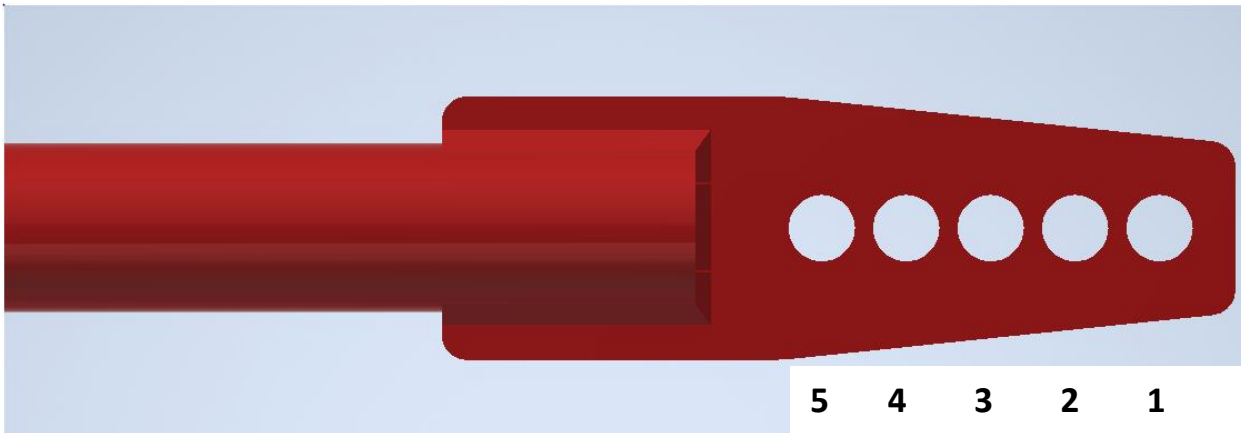

Spring Rate options available

| Hole | Spring Rate [lb/in] |
|------|---------------------|
| 5    | 630                 |
| 4    | 575                 |
| 3    | 520                 |
| 2    | 475                 |
| 1    | 440                 |

## **UMI Performance**

**4080-1**

**1 ¼ Splined Sway Bar**

509 Hemlock Street  
Philipsburg, PA 16866  
814.343.6315

***Proudly made in the U.S.A***

### **Warranty Information**

UMI Performance warrants all UMI Performance products for a period of two (2) years from the original date of purchase.

This warranty is valid against defects in materials and workmanship for the two (2) year warranty period. It is not valid against defect resulting from, but not limited to:

Misuse and/or abuse, neglect or accident, Exceeding the item's design limits, Improper installation. Acts of God, including lightning, floods, earthquakes, fire or high winds. Damage in handling, including damage encountered during shipment.

This warranty is valid for the original purchaser of the UMI Product. Warranty is not transferable or valid for second ownership.

This warranty shall be considered void if the warranted product is in any way altered, adjusted, tampered with or defaced.

The two (2) year warranty does not apply to normal wear and tear (the gradual deterioration of an asset which results naturally from use and/or age, i.e. bearings, bushings, etc.).

Non UMI manufactured parts are not covered or valid under this UMI Performance warranty.

UMI Performance cannot guarantee compatibility or performance of its products with other components used in conjunction with UMI Performance products.

UMI Performance cannot assume responsibility for any damages to UMI Products nor for claims for personal injury or property damage resulting from the use of UMI Performance products or the improper operation thereof or consequential damages arising from the products or use of the products.

UMI Performance two (2) year warranty excludes incidental charges incurred by the end user in the event of breakage (towing, labor, installation, etc.). By their very nature, competition suspension parts are continuously expected to exceed to their limits (either by race or road use). UMI suspension components are designed to withstand intense race conditions, although it is impossible to control the quality of installation or the varying conditions in which they are used.

This warranty supersedes all other warranties and may only be modified by statement in writing, signed by UMI Performance owners/principals.

All Warranties implied by law, including the warranties of merchantability and fitness for a particular purpose, are hereby limited to the warranty period herein and shall expire at the end of such period.